

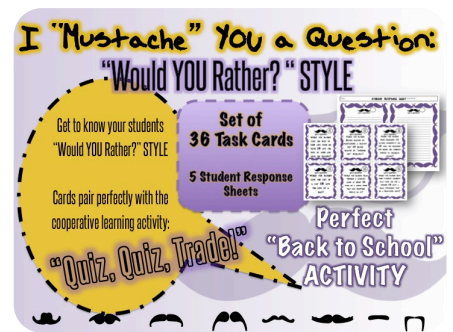

# THANK YOU FOR YOUR SUPPORT!

AGAIN, I CAN'T THANK YOU ENOUGH FOR PURCHASING THIS PRODUCT! I HOPE IT WORKS AS WELL IN YOUR CLASSROOM AS IT DOES IN MINE!



On July 24, 2014, Darlene Anne (TpT Seller) said:

I want to thank you for this clever, original, and generous product! My middle schoolers are going to love it :) Thanks so much!

On July 25, 2014, Wild About Fifth Grade (TpT Seller) said:

This is such a creative idea that I know my students will love. I can't wait to use it when we get back in September! Thank you for generously sharing with the TPT community!



MORE ENGAGING LESSONS,  
ACTIVITIES AND TASK  
CARDS



CLASSROOM TIPS, TRICKS  
AND RESOURCES STRAIGHT  
FROM ROOM 30

**NO-PREP POWERPOINT  
+ PRINTABLES**

COMPLEX  
CHARACTERS  
STEALING

## FEATURING

## Instagram CHARACTER TRAIT ACTIVITY

**CCSS ALIGNED: RL 8–12.3**  
**ADVANCED MIDDLE AND HIGH SCHOOL**

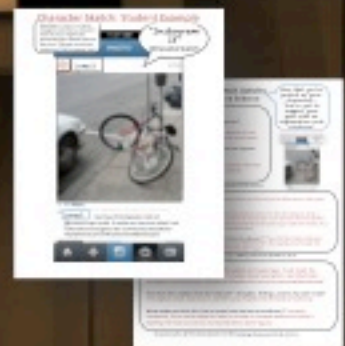



CLEAR & COMPLETE  
LESSON AND ACTIVITIES

14 SLIDE  
POWERPOINT

GRAPHIC  
ORGANIZERS

**S** - SPEECH  
**T** - THOUGHTS  
**E** - EFFECTS ON  
OTHERS  
**A** - ACTIONS  
**L** - LOOKS

TEACHER'S  
GUIDE

Instagram  
CHARACTER  
TRAIT  
ACTIVITY

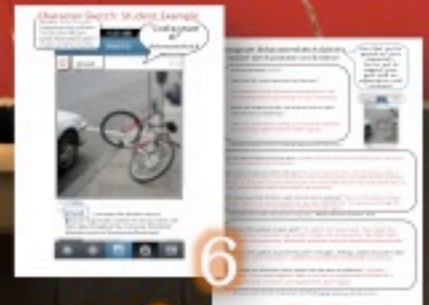

6

Printable  
Pages

INTRODUCE OR RE-TEACH

CCSS RL 8-12.3



## TWO TYPES OF CHARACTERIZATION

## DIRECT vs. INDIRECT

**DIRECT**

**INDIRECT**

**TELLS**

the audience what the **PERSONALITY TRAITS** of the character are...

**EXAMPLE:** THE OVER-SIZED MONSTER STUMBLED THROUGH THE ROOM, WHICH WAS A DAILY OCCURRENCE.

**SHOWS**

the audience the **PERSONALITY TRAITS** of the character through **5 UNIQUE METHODS...**

**EXAMPLE:** "DO YOU THINK I COULD WALK IN HERE ONE DAY WITHOUT TRIPPING OVER SOMETHING?" SAID SULLY.

## GRAPHIC ORGANIZERS

## CHARACTERIZATION SKILLS

**CHARACTER PROFILE:**

- SULLY
- 16 YEARS OLD
- HIGH SCHOOL JUNIOR
- PLAYS VOLLEYBALL
- OUTGOING
- HIGH-STRESS
- JEALOUS OF BEST FRIEND
- BROKEN ARM

**CHARACTERIZATION TASK:** USE THE CHARACTER PROFILE TO THE LEFT TO CREATE A COMPLEX CHARACTER NAMED SALLY. THIS WILL BE THE MAIN CHARACTER IN A SHORT NARRATIVE WRITTEN BY THE NEXT BEST-SELLING AUTHOR... YOU!!

1. WITHIN A ONE-PAGE NARRATIVE, TRANSFORM SALLY INTO A COMPLEX CHARACTER BY USING ALL 5 METHODS OF INDIRECT CHARACTERIZATION AND **ONE** EXAMPLE OF **DIRECT** CHARACTERIZATION.
2. LABEL EACH EXAMPLE OF CHARACTERIZATION WITH THE METHOD USED.

## 14 SLIDE POWERPOINT

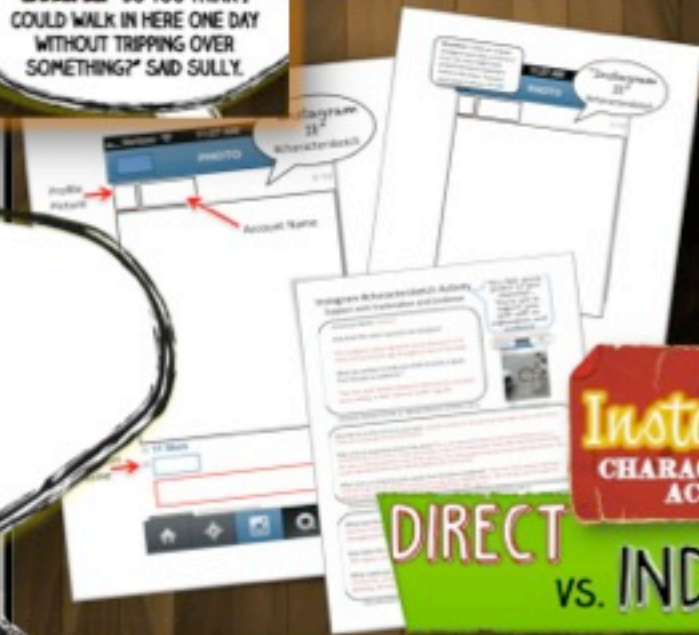

## Instagram CHARACTER TRAIT ACTIVITY

## DIRECT vs. INDIRECT

# INTRODUCE OR RE-TEACH

**CCSS RL 8-12.3**

**SPEECH**

**INDIRECT CHARACTERIZATION**

**SHOWS**

JERRY HURRIED OVER TO THE GIRL AND WHISPERED, "I DON'T LIKE BEING SURROUNDED BY LARGE GROUPS OF PEOPLE. I DON'T FEEL WELL..."

1. WHAT DO WE KNOW ABOUT JERRY BASED ON "WHAT" HE SAID?
2. DOES "HOW" HE SAID IT SAY ANYTHING ELSE ABOUT HIS CHARACTER?

Characters **REVEAL** things about themselves through **WHAT** they said and **HOW** they say it...



CLEAR & COMPLETE  
LESSON AND ACTIVITIES

14 SLIDE  
POWERPOINT

GRAPHIC  
ORGANIZERS

TEACHER'S  
GUIDE

S - SPEECH  
T - THOUGHTS  
E - EFFECTS ON  
OTHERS  
A - ACTIONS  
L - LOOKS

Instagram  
CHARACTER  
TRAIT  
ACTIVITY

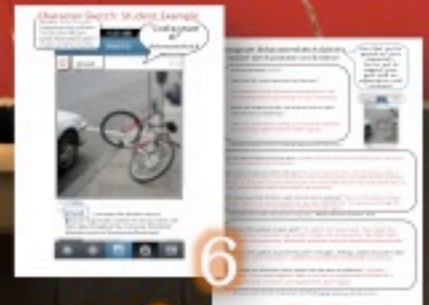

INTRODUCE OR RE-TEACH

CCSS RL 8-12.3

Printable  
Pages





# DEVELOPING COMPLEX CHARACTERS IN LITERATURE

Think back to the last story or book that you read and identify one of the main characters...

CHOOSE THREE WORDS  
THAT BEST DESCRIBE  
THAT CHARACTER...  
SHARE WITH A PARTNER.

# VOCABULARY

**COMPLEX CHARACTER** A CHARACTER WHOSE PERSONALITY, BACKGROUND, MOTIVES AND OTHER FEATURES ARE FULLY **PORTRAYED** BY THE AUTHOR.

**CHARACTERIZATION** THE PROCESS BY WHICH THE WRITER REVEALS THE PERSONALITY OF A CHARACTER.

TWO TYPES OF  
CHARACTERIZATION

**DIRECT**

VS.

**INDIRECT**



# TWO TYPES OF CHARACTERIZATION

## DIRECT VS. INDIRECT

**TELLS**

**DIRECT**

the audience  
what the  
**PERSONALITY TRAITS** of the  
character are...

**EXAMPLE:** THE OVER-SIZED  
MONSTER STUMBLED THROUGH THE  
ROOM, WHICH WAS A DAILY  
OCCURRENCE.

**INDIRECT**

the  
audience  
the  
**PERSONALITY TRAITS** of  
the character through  
**5 UNIQUE METHODS...**

**SHOWS**

**EXAMPLE:** "DO YOU THINK I  
COULD WALK IN HERE ONE DAY  
WITHOUT TRIPPING OVER  
SOMETHING?" SAID SULLY.

## 5 METHODS OF

# INDIRECT

## CHARACTERIZATION

SHOWS

- S** - SPEECH  
**T** - THOUGHTS  
**E** - EFFECTS ON OTHERS  
**A** - ACTIONS  
**L** - LOOKS

THESE ARE "TOOLS"  
AUTHORS USE TO  
**SHOW**  
A CHARACTER'S  
**PERSONALITY**  
**TRAITS.**



# SPEECH

# INDIRECT

SHOWS

## CHARACTERIZATION

JERRY HURRIED OVER TO THE GIRL AND WHISPERED, "I DON'T LIKE BEING SURROUNDED BY LARGE GROUPS OF PEOPLE. I DON'T FEEL WELL..."

1. WHAT DO WE KNOW ABOUT JERRY BASED ON "WHAT" HE SAID?
2. DOES "HOW" HE SAID IT SAY ANYTHING ELSE ABOUT HIS CHARACTER?

Characters **REVEAL** things about themselves through **WHAT** they said and **HOW** they say it...

# THOUGHTS

# INDIRECT

SHOWS

## CHARACTERIZATION

"I KNEW I COULDN'T GO BACK HOME. HOW WOULD I FACE THEM? WHAT WOULD I SAY? I SAT THERE IN THE ROAD WISHING THAT I HAD NEVER MADE THE IMMATURE DECISION TO RUN AWAY FROM HOME."

1. WHAT DO WE KNOW ABOUT THE NARRATOR BASED ON HIS OR HER THOUGHTS?

Characters **REVEAL** things about themselves through their **THOUGHTS** as the **NARRATOR** in the story...



# EFFECTS ON OTHERS

# INDIRECT

## CHARACTERIZATION

SHOWS

"THE BOY  
REALIZED THAT HE  
COULDN'T PLAY  
WITH THE SAME  
FRIENDS AS HE DID  
YESTERDAY  
BECAUSE BILLY  
WAS BACK AT  
SCHOOL TODAY."

ASK YOURSELF THE FOLLOWING:

HOW DO OTHERS ACT OR REACT TO  
SITUATIONS WITH THE CHARACTER?

DOES THE CHARACTER CAUSE OTHERS  
TO ACT IN A CERTAIN WAY?

**DID BILLY CAUSE THE BOY TO ACT  
DIFFERENTLY THAN USUAL? WHAT DOES THIS  
SAY ABOUT BILLY? OR THE BOY?**

# ACTIONS

# INDIRECT

SHOWS

## CHARACTERIZATION

HENRY THREW HIS DRINK TOWARDS THE FLOOR AS HE HEARD THE NEWS. ICE SCATTERED ACROSS THE FLOOR. HIS RIGHT LEG SUDDENLY HAD A MIND OF ITS OWN AND KICKED THE LARGEST PART OF THE BROKEN GLASS THROUGH THE BREEZEWAY.

1. WHAT DOES THE CHARACTER DO?

1. WHAT DOES THIS SAY ABOUT HIS CHARACTER?

Characters **REVEAL** things about themselves through **WHAT** they **DO**...



# LOOKS

# INDIRECT

# SHOWS

## CHARACTERIZATION

SHE HAD BEEN WAITING FOR HER BIRTHDAY PARTY NOW FOR 364 DAYS, WHICH WAS THE DAY HER PARENTS THREW HER THE LAST BIRTHDAY PARTY. HER EYES GLEAMED WITH EXCITEMENT. HER SMILE SHOWED EVERY SINGLE TOOTH IN HER MOUTH AND THEN SOME.

1. DOES THE AUTHOR GIVE US A PHYSICAL DESCRIPTION OF THE CHARACTER?

2. WHAT DOES THE CHARACTER LOOK LIKE?

The author or narrator **REVEAL** things about characters by describing their **PHYSICAL APPEARANCE...**



# CHECK FOR UNDERSTANDING

1. HOW DOES AN AUTHOR CREATE ONE OR MORE COMPLEX CHARACTERS WITHIN A STORY?

2. **DIRECT OR INDIRECT:** AFTER NINETY MINUTES OF MIXING AND MATCHING, AND CELL-PHONING HER SISTER THREE TIMES FOR ADVICE, JULIE FINALLY MADE UP HER MIND.

3. **DIRECT OR INDIRECT:** SHE WAS SHY. IT WAS MORE CLEAR THAN EVER. EVEN HER FRIENDS ADMITTED THAT SHE WAS NEVER THE SAME AFTER THE TRAUMATIC EVENT.

4. IDENTIFY ONE METHOD OF INDIRECT CHARACTERIZATION THAT MIGHT BE USED MOST BY AUTHORS AND EXPLAIN WHY YOU CHOSE IT.



# MASTERY OF CHARACTERIZATION SKILLS

## CHARACTER PROFILE:

- SALLY
- 16 YEARS OLD
- HIGH SCHOOL JUNIOR
- PLAYS VOLLEYBALL
- OUTGOING
- HIGH-STRESS
- JEALOUS OF BEST FRIEND
- BROKEN ARM

## CHARACTERIZATION TASK:

USE THE CHARACTER PROFILE TO THE LEFT TO CREATE A COMPLEX CHARACTER NAMED SALLY. THIS WILL BE THE MAIN CHARACTER IN A SHORT NARRATIVE WRITTEN BY THE NEXT BEST-SELLING AUTHOR... YOU!!

1. WITHIN A ONE-PAGE NARRATIVE, TRANSFORM SALLY INTO A COMPLEX CHARACTER BY USING ALL 5 METHODS OF INDIRECT CHARACTERIZATION AND ONE EXAMPLE OF DIRECT CHARACTERIZATION.
2. LABEL EACH EXAMPLE OF CHARACTERIZATION WITH THE METHOD USED.

# MASTERY OF CHARACTERIZATION SKILLS

## CHARACTER PROFILE:

- SALLY
- QUIET
- NOT PASSING
- MATH CLASS

DIRECT  
CHARACTERIZATION

## CHARACTERIZATION TASK

### EXAMPLE:

**She was a quiet girl.** It was obvious since the day that she was born. She rarely cried as a baby and rarely spoke in school.

**Because of this, Sally's English teacher was surprised when sally stood up in class and yelled, "This is frustrating. I don't understand this kind of math... I'll never get it!"**

INDIRECT  
CHARACTERIZATION:  
SPEECH



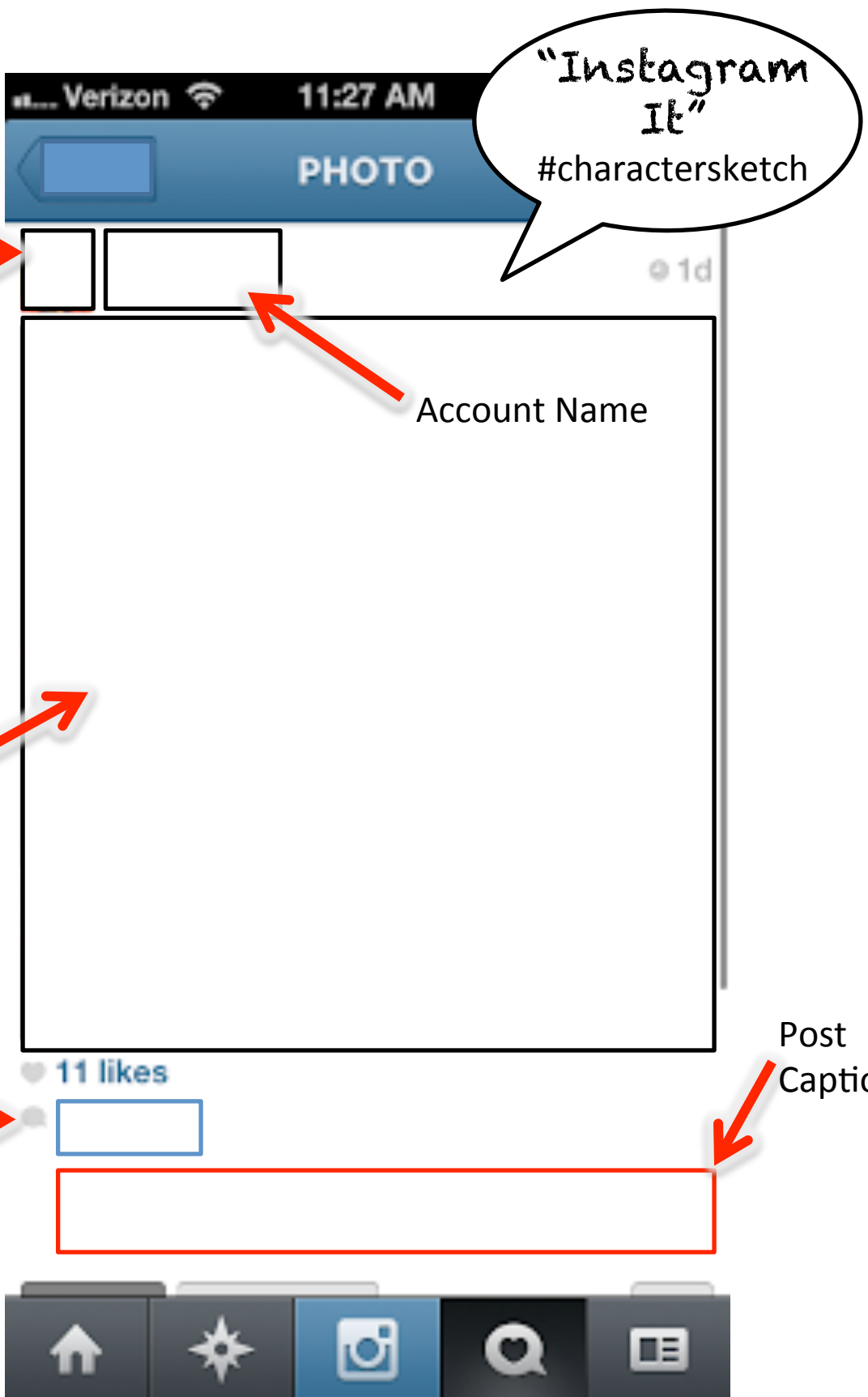

Profile  
Picture

Posted  
Photo

Account  
Name

Account Name

Post  
Caption

**Directions:** Create an original Instagram post that a character from the story might have posted during an important event in the story. The post must show evidence of **ONE** character trait.

11:27 AM

PHOTO

"Instagram  
It"

#charactersketch

1d

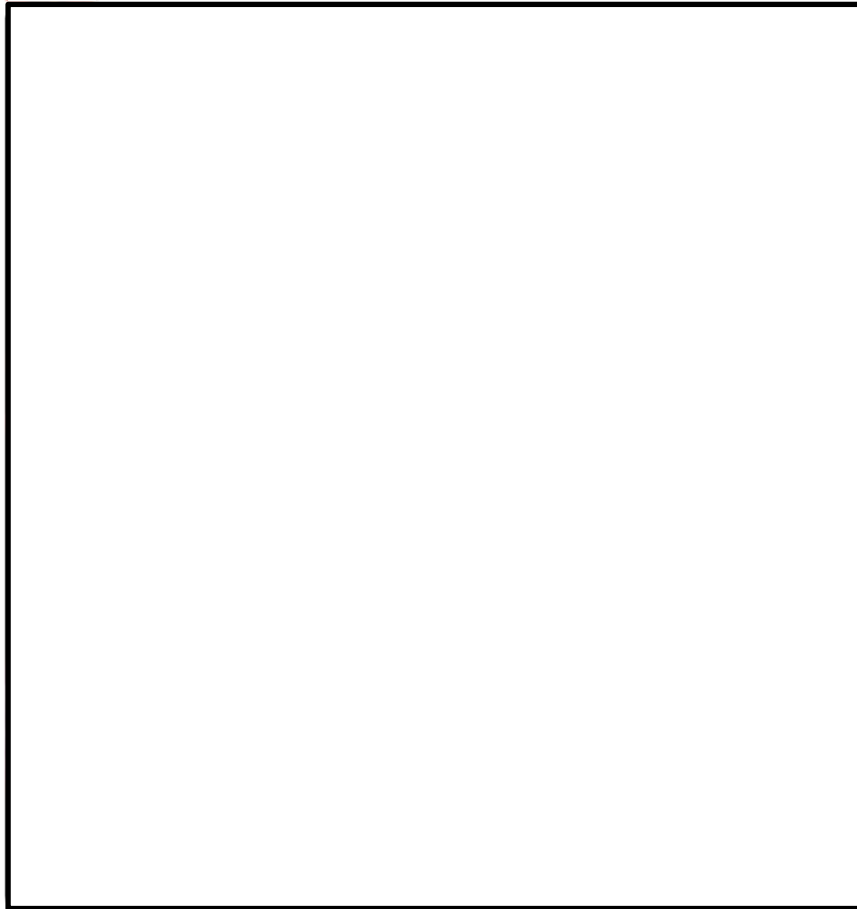

11 likes

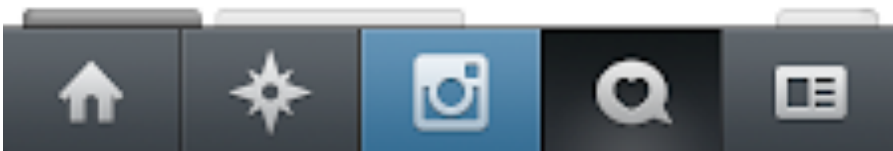



# Instagram #charactersketch Activity

## Support with Explanation and Evidence

Now that you've posted as your character... You've got to support your post with an explanation and evidence!

IG Account Name:

How does this name represent the character?

What was written to make you think this (cite a quote from the text as evidence) ?

### Character Sketch: Student Example

Directions: Create an original Instagram post that a character from the story might have posted during a specific event in the story. The post must show evidence of ONE character trait.

11:27 AM

PHOTO

"Instagram It?"  
#charactersketch

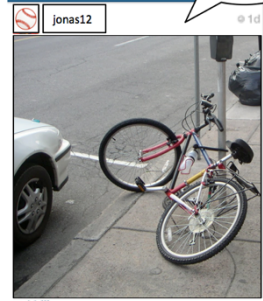

11 likes

jonas12

I just heard the Speaker instruct everyone to

Character Analysis (CCS RL.3) Making Inferences (CCS RL.1; RI.1)

Describe the profile picture in your post:

Why is this an important event in the story?

What made you think this (cite a quote from the text as evidence)?

Characterization & Plot Development (CCS RL3) Making Inferences (CCS RL.1; RI.1)

What was the caption on your post?

How does this caption show the character's thoughts or feelings?

What made you think this (cite a quote from the text as evidence)?

Characterization & Plot Development (CCS RL3) Making Inferences (CCS RL.1; RI.1)

# Character Sketch: Student Example

Directions: Create an original Instagram post that a character from the story might have posted during a specific event in the story. The post must show evidence of **ONE** character trait.

11:27 AM

PHOTO

"Instagram  
It"

#charactersketch



jonas1

1d



11 likes

jonas1

I just heard the Speaker instruct @everyone to go inside. It makes me nervous when I see fallen bikes throughout the community. #ilostAsher #Speakerisincontrol #someone will bereleased





# Instagram #charactersketch Activity

## Support with Explanation and Evidence

IG Account Name: **Jonas12**

How does this name represent the character?

This Instagram name represents Jonas because it is his name followed by his age throughout most of the book.

What was written to make you think this (cite a quote from the text as evidence) ?

"But now, with Twelve coming so soon and the volunteer hours ending, it didn't seem to matter" (pg 26).

Character Analysis (CCS RL.3) Making Inferences (CCS RL.1; RI.1)

Now that you've posted as your character... You've got to support your post with an explanation and evidence!

Character Sketch: Student Example

Directions: Create an original Instagram post that a character from the story might have posted during a specific event in the story. The post must show evidence of ONE character trait.

11:27 AM

PHOTO

"Instagram It" #charactersketch

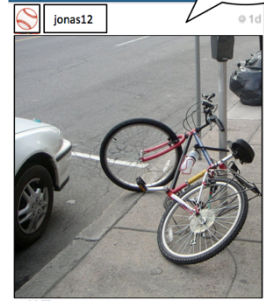

Describe the profile picture in your post: I posted a photo of a bicycle that has fallen over in the street. There are no people around the bicycle.

Why is this an important event in the story? This is an important event in the story because Jonas is remembering a time when a Pilot had broken a rule in the community. Soon after the Pilot had broken the rule, an announcement came of the Speaker that demanded everyone to go inside their homes. As a result, abandoned bikes were left throughout the community.

What made you think this (cite a quote from the text as evidence)? "Then all of the citizens had been ordered to go into the nearest building and stay there. IMMEDIATELY, the rasping voice through the speakers had said. LEAVE YOUR BICYCLES WHERE THEY ARE" (pg 2).

Characterization & Plot Development (CCS RL3) Making Inferences (CCS RL.1; RI.1)

What was the caption on your post? The caption on my post was, "I just heard the Speaker instruct everyone to go inside. It makes me nervous when I see fallen bikes throughout the community. #ilostAsher #Speakerisincontrol #someone will be released."

How does this caption show the character's thoughts, feelings, and/or character traits? This caption shows that Jonas is obedient and respects the demands of authority.

What made you think this (cite a quote from the text as evidence)? "Instantly, obediently, Jonas had dropped his bike on its side on the path behind his family's dwelling. He had run indoors and stayed there, alone" (pg 2).

Characterization & Plot Development (CCS RL3) Making Inferences (CCS RL.1; RI.1)